

Heritage

GOOSENECK



The all-aluminum Heritage gooseneck provides the legendary strength and durability of a Jamco at an exceptional value. It's similar in price to other trailers in its size category, but with Jamco's patented interlocking aluminum plank walls on the lower half and HammerTest™ aluminum bonded core walls on the upper half, it's far superior to the skin-on-frame design of typical trailers. All Heritage gooseneck models are semi-custom, allowing for specific selection and placement of many options, and carry a seven year frame warranty and twenty year pro-rated warranty on plank walls.

MODEL	HORSES	LOAD TYPE	HITCH	DRESS/LO	DRESS/LO LENGTH	WIDTH	HEIGHT	BED LENGTH	OVERALL LENGTH
Heritage II	2, 3 or 4	Slant	Gooseneck	Dress Standard	4'	7'	7'	14', 18' or 22'	22', 26' or 30'
Heritage III	3 or 4	Slant	Gooseneck	Dress Standard	6'	7'	7'	20' or 24'	28' or 32'





Available on many Jamcos is our unique QuickChange™ post system, which allows for day-to-day changes in the divider configuration, and movement of rear-tack saddle racks. A simple spring-sleeve design is grasped and pulled down, which allows the post to be moved to another pre-drilled location.

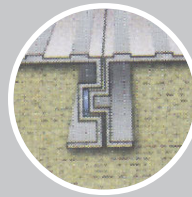

Superior engineering versus rivets and bolts: our walls and floors are constructed with interlocking aluminum planks that are unitized with continuous welds for virtually one-piece strength.*

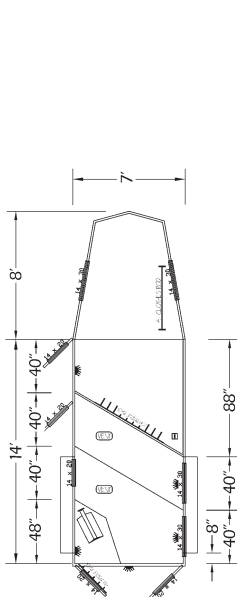
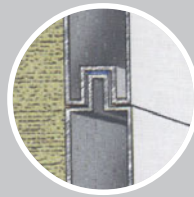

HERITAGE II
Two horse gooseneck
with 4' dressing room

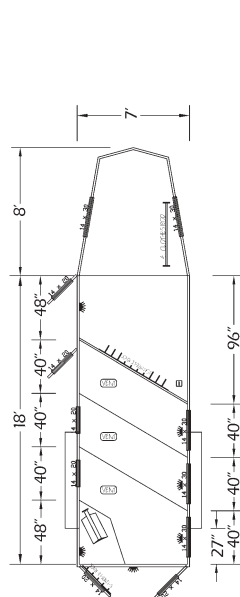

HERITAGE II
Three horse gooseneck
with 4' dressing room

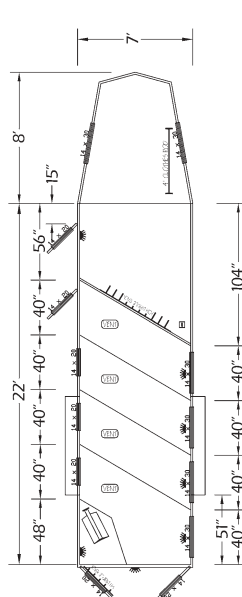

HERITAGE II
Four horse gooseneck
with 4' dressing room

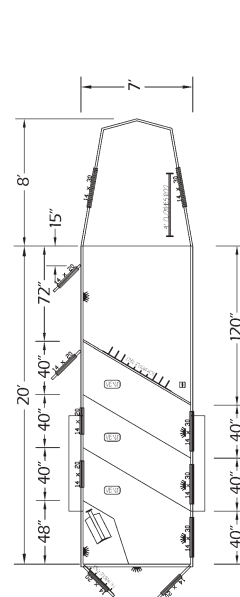

HERITAGE III
Three horse gooseneck
with 6' dressing room

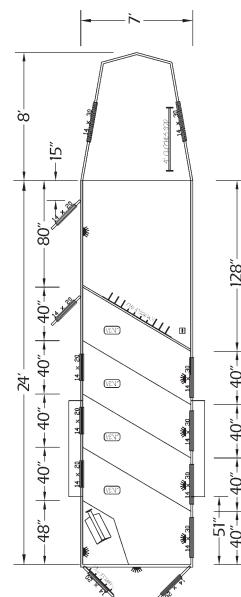

HERITAGE III
Four horse gooseneck
with 6' dressing room

Features

- White baked on enamel finish
- Lower body: patented* tongue-and-groove double-thick interlocking aluminum planks
- Upper body: HammerTest™ aluminum/fiber-core bonded panels
- Interlocking aluminum SuperPlank™ floor with crossmembers every 4.5"
- Seamless, single-piece aluminum roof
- Aerodynamic tapered gooseneck nose design
- Heavy duty Diamond Plate aluminum teardrop fenders
- Fender signal lights
- Dual (Hi/Lo) tail lights
- Electric brakes on all wheels
- Electric breakaway kit
- Heavy duty wiring
- Sealed beam and shock-resistant lighting
- All DOT required lighting and striping
- Rubber floor and wall mats in horse area
- Well lit interiors
- Windows in nose
- Adjustable 2 5/16" cone coupler
- Manual single jack
- Modular wheel design with chrome center caps
- Spare tire, carrier, and cover
- Diamond Plate aluminum running boards
- Tandem Dexter Torflex™ axles: 3,500-5,200 lb
- 60/40 rear doors with 14" x 20" windows and QuickChange™ removable center post

- Removable bridle rack with 5 hooks on rear door
- Drop-down feed door with window and safety grate in front of each stall except first stall
- Window with horse guard behind each stall
- One two-way pop up forced-air vent per stall
- Aluminum slant dividers
- Heavy duty interior tie rings, two at front of each stall
- Heavy duty exterior tie rings, one per horse
- Collapsible rear-tack
- Rear-tack saddle rack with QuickChange™ removable post and extra location in dressing room
- One roadside escape door with window
- Padded chest strap, first horse (at escape door)
- Padded butt strap, last horse

Dressing room complete with:

- Slant wall separating horse area from dressing room
- Carpeted lower half of slant wall
- Carpeting inside on forward deck
- Door with window and deadbolt
- Rubber floor mats
- Lighting with wall switch
- Bridle rack with ten hooks
- Carpeted brush box
- Clothes rod

Popular Options

- J2000 Series or other custom graphics/logo
- Rear ramp with dual-camlock curtain style upper doors and windows
- Divider pads
- Additional bridle racks
- Additional saddle racks
- Hydraulic jack(s), single or double
- Chrome fold-up step to forward deck
- Pass-through door from dressing room to horse area
- Mangers with exterior access door

To contact dealer:

