

Freedom



Freedom is the absolute ultimate in living quarters trailers. From the size of your living area to the number of horses you can carry, this fully custom home-away-from-home can be as simple or luxurious as you want it to be. With the legendary Jamco name behind it and your custom built interior, you'll be pulling the very best trailer imaginable. In general, you can expect to be able to fit A/C, two water holding tanks, a small refrigerator, microwave oven, shower, sleeping area, flush toilet, sink and convertible seating/sleeping area... all decorated to your exact specifications. All Freedoms carry a seven year frame warranty and twenty year pro-rated warranty on plank walls. Contact your dealer for details and ideas. If you don't see what you're looking for, just ask!

MODEL	HORSES	LOAD TYPE	HITCH	DRESS/LQ	DRESS/LQ LENGTH	WIDTH	HEIGHT	BED LENGTH	OVERALL LENGTH
Freedom I	2 - 6	Slant	Gooseneck	Full LQ	10'	7' or 8'	7'6"	21' - 35'	29' - 43'
Freedom II	2	Straight	Gooseneck	Full LQ	10'	7' or 8'	7'6"	23'	31'





Available on many Jamcos is our unique QuickChange™ post system, which allows for day-to-day changes in the divider configuration, and movement of rear-tack saddle racks. A simple spring-sleeve design is grasped and pulled down, which allows the post to be moved to another pre-drilled location.

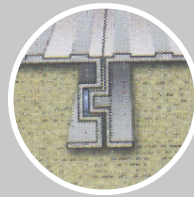

Superior engineering versus rivets and bolts: our walls and floors are constructed with interlocking aluminum planks that are united with continuous welds for virtually one-piece strength.*

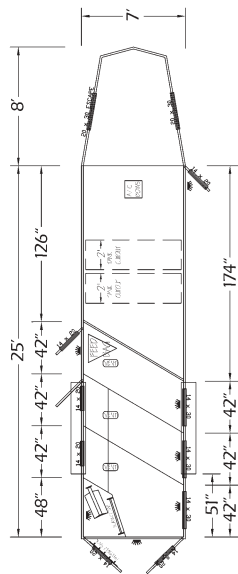
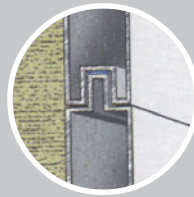

FREEDOM I
7' wide three horse slant load gooseneck with mangers

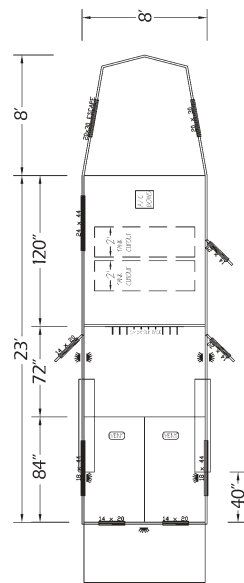

FREEDOM II
8' wide two horse straight load gooseneck

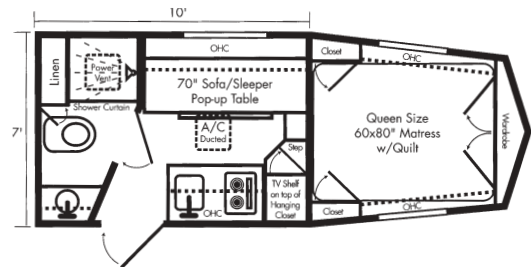

FREEDOM II
Sample interior



Features

- White baked on enamel finish
- Patented* tongue-and-groove double-thick aluminum interlocking plank walls
- Interlocking aluminum SuperPlank™ floor with crossmembers every 4.5"
- Seamless, single-piece aluminum roof
- Aerodynamic tapered gooseneck nose design
- Heavy duty Diamond Plate aluminum teardrop fenders
- Fender signal lights
- Dual (Hi/Lo) tail lights
- Electric brakes on all wheels
- Electric breakaway kit
- Heavy duty wiring
- Sealed beam and shock-resistant lighting
- All DOT required lighting and striping
- Well lit interiors
- Adjustable 2 5/16" cone coupler
- Fender signal lights
- Spare tire with carrier and cover
- Distinctive stainless steel wheel covers
- Diamond Plate aluminum running boards (not available on 8' wide)
- Tandem Dexter Torflex™ axles: 3,500-8,000 lb
- Screen door on living quarters door
- Rubber floor and wall mats in horse area
- Large windows in nose, one of kick-out style for safety
- 50/50 rear doors (7' wide Freedom I) or 60/40 rear doors (8' wide Freedom I)
- Rear ramp with dual-camlock curtain-style upper doors and windows (Freedom II)
- One two-way pop up forced-air vent per stall
- Heavy duty interior tie rings
- Heavy duty exterior tie rings, one per horse
- Permanent rear tack including saddle rack, carpeted brush box, blanket bars, and bridle rack with five hooks (Freedom I)
- Removable bridle rack with ten hooks (Freedom II)
- Drop-down feed door with window and safety grate in front of each stall (Freedom I)
- Window with horse guard behind each stall for cross-ventilation (Freedom I)
- Padded aluminum dividers
- One roadside escape door with window (3+ horse models)
- Padded chest strap, first horse at escape door (Freedom I)
- Padded butt strap, last horse (Freedom I)
- Padded chest and butt straps (Freedom II)
- Manual 2-speed double jack
- Wall separating horse area and living quarters
- Curbside LQ door with window and deadbolt

Popular Options

- Logo or other custom graphics
- Rear ramp with dual-camlock curtain-style upper doors and windows (Freedom I)
- 50/50 rear doors (Freedom II)
- Extra width and height
- Hydraulic double jack
- Slide-out aluminum step (under LQ door)
- Pass-through door from mid-tack to horse area
- Mangers with exterior access doors
- Removable feed bags
- Collapsible rear tack with QuickChange™ post

Mid tack room, with your choice of:

- Rubber floor mats
- Carpeted rear wall
- Bridle and saddle racks
- Clothes rods or brush trays
- Lighting with wall switch
- Door with window and deadbolt

To contact dealer:

