

# Competitor



The absolute ultimate in straight-load trailers, the all-aluminum Competitor is fully custom, with an amazing number of options and choices for both riding and driving horses. With Jamco's QuickChange™ post and divider system, these trailers may be changed from day to day to a multitude of configurations, depending on the size you choose. For example, the six horse Competitor III with optional box stall dividers may be configured with up to three horses in the front, and a vehicle (an ATV, golf cart, etc.) in the back which can then become a cross tie area or box stall upon arrival. Or you may configure it with four large stalls, three box stalls, or whatever you desire. The Competitor allows for a choice of width, height and length, along with the specific selection and placement of the many available options, and carries a seven year frame warranty and twenty year pro-rated warranty on plank walls.

MODEL	HORSES	LOAD TYPE	HITCH	DRESS/LO	DRESS/LO LENGTH	WIDTH	HEIGHT	BED LENGTH	OVERALL LENGTH
Competitor	2	Straight	Gooseneck	Dress Optional	4'	6'	7'6"	10' or 15'	18' or 23'
Competitor I	2	Straight	Gooseneck	Dress Optional	4'	7'	7'6"	10', 15', 17', 21'	18', 23', 25', 29'
Competitor II	4	Head to Head	Gooseneck	Dress Optional	4'	7'	7'6"	24' or 28'	32' or 36'
Competitor III	6	Head to Head	Gooseneck	Dress Optional	4'	8'	7'6"	24' or 28'	32' or 36'
Competitor IV	6	Head to Head	Gooseneck	Dress Optional	4'	8'	7'6"	28' or 32'	36' or 40'





Available on many Jamcos is our unique QuickChange™ post system, which allows for day-to-day changes in the divider configuration, and movement of rear-tack saddle racks. A simple spring-sleeve design is grasped and pulled down, which allows the post to be moved to another pre-drilled location.

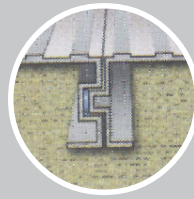

Superior engineering versus rivets and bolts: our walls and floors are constructed with interlocking aluminum planks that are united with continuous welds for virtually one-piece strength.\*

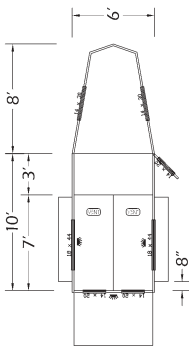
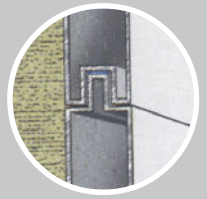

**COMPETITOR**  
Two horse gooseneck

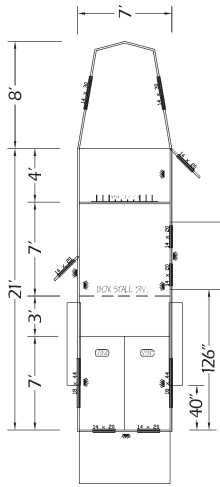

**COMPETITOR I**  
Two horse gooseneck with dressing room

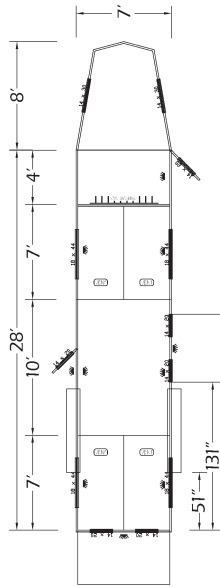

**COMPETITOR II**  
Four horse gooseneck with dressing room

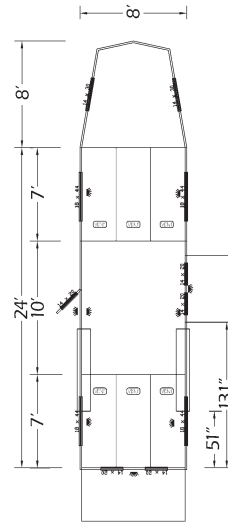

**COMPETITOR III**  
Six horse gooseneck

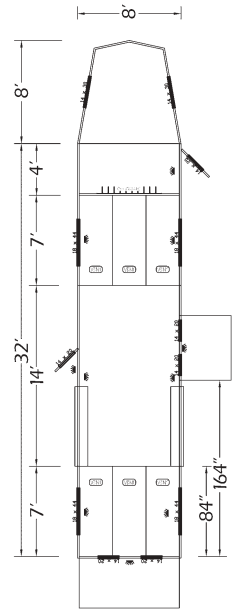

**COMPETITOR IV**  
Six horse gooseneck with dressing room

## Features

- White baked on enamel finish
- Patented\* tongue-and-groove double-thick aluminum interlocking plank walls
- Interlocking aluminum SuperPlank™ floor with crossmembers every 4.5"
- Seamless, single-piece aluminum roof
- Aerodynamic tapered gooseneck nose design
- Heavy duty Diamond Plate aluminum teardrop fenders
- Fender signal lights
- Dual (Hi/Lo) tail lights
- Electric brakes on all wheels
- Electric breakaway kit
- Heavy duty wiring
- Sealed beam and shock-resistant lighting
- All DOT required lighting and striping
- Well lit interiors
- Adjustable 2 5/16" cone coupler
- Spare tire with carrier and cover
- Tandem Dexter Torflex™ axles: 3,500-8,000 lb
- Distinctive stainless steel wheel covers
- Diamond Plate aluminum running boards (not available on 8' wide)
- Rubber floor and wall mats in horse area
- Large windows in nose

- 5' side ramp with dual-camlock curtain-style upper doors and windows (Competitor I, II, III and IV)
- Rear ramp with dual-camlock curtain-style upper doors and windows
- One two-way, framed, pop-up forced-air roof vent per stall
- One 18" x 44" window in each stall
- Padded butt and chest straps
- Padded aluminum body dividers
- QuickChange™ removable posts
- Heavy duty interior tie rings
- Heavy duty exterior tie rings, one per horse
- Manual single speed jack
- One escape door with window

Dressing room (where applicable), complete with:

- Straight wall separating horse area and dressing room
- Carpeted back wall and forward deck
- Curbside door with window and deadbolt
- Rubber floor mats
- Bridle rack with ten hooks
- Lighting with wall switch

## Popular Options

- Logo or other custom graphics
- 50/50 rear doors
- Oversized (24" x 44") windows in each stall
- Box stall dividers
- Additional bridle racks
- Saddle racks
- Clothes rods
- Brush trays
- Extra width and height
- Hydraulic jack(s)
- Chrome fold-up step to forward deck of gooseneck
- Slide-out aluminum step (under dressing room door)
- Pass-through door from dressing room to horse area
- Various tire and axle sizes available

To contact dealer:

